

RadiaLED® Optimum Range

Installation instructions for RadiaLED® bulkhead



WARNINGS AND CAUTIONS

- To avoid electric shock ⚠ or serious injury or property damage, isolate power before installing, removing or servicing the product
- It is recommended that this product is installed by an electrician or a competent person with sufficient experience to install this product
- To be installed in accordance with the local current wiring regulations and standards
- Any broken or damaged parts should be replaced as soon as possible
- Do not operate the CCT switch whilst fitting is on, turn off power to change colour temperature
- JCC will not accept responsibility for claims arising from sub-standard installations; which will void the warranty
- Ensure that you have the tools and accessories required to complete the installation correctly
- The light source of this luminaire is not replaceable: when the light source reaches the end of its life the whole of the luminaire must be replaced
- This luminaire is suitable for indoor use or exterior use

INSTALLATION INSTRUCTIONS

ENGLISH

Read instructions and check that you have all of the tools and accessories required to complete the installation correctly. Isolate power supply before starting the installation. Ensure that there is adequate free air ventilation around the fitting. The installation must not infringe on water pipes or any other electrical services.

Specifications: Ra: 80

Wattage	Colour Temp	Lumens	LpcW
Standard			
8W	4000K	750	94
12W	4000K	1300	108
18W	4000K	1900	106
Colour Temperature selectable(CCT)			
8W	3000K/4000K	750	94
12W	3000K/4000K	1300	108
18W	3000K/4000K	1900	106

- Isolate power supply.
- All termination points are under the LED tray, and this can be removed by loosening the three locating screws and rotating the tray until keyhole slots allow removal.
- Feed mains and dimming control (where required) through grommet or CTS gland.
- Fix base in desired location, taking care to avoid hidden pipes and cables. Ensure the three flat rubber washers are used on the fixing screws to maintain IP rating
- Connect mains supply connections as per Fig.1
- For DALI/1-10V dimmable versions, connect dimming controls as per Fig.2
- Re-attach LED tray to mounts and tighten screws.
- For CCT version select required colour temperature as per Fig.3 (do not operate CCT switch when light is on)
- For microwave dimming versions refer to separate instructions to apply required settings
- Fit the diffuser by aligning the three locating lugs on the diffuser with the three lugs on the rim of the base.
- Rotate the diffuser clockwise until tight; ensure gasket is seated correctly.
- Tighten the diffuser retaining screw ensuring the rubber washer in place shown in Fig.4
- Switch on the mains. Test for operation.

Figure.1

Mains supply Input : 220-240V~ 50/60Hz Class 1/2 ⚡

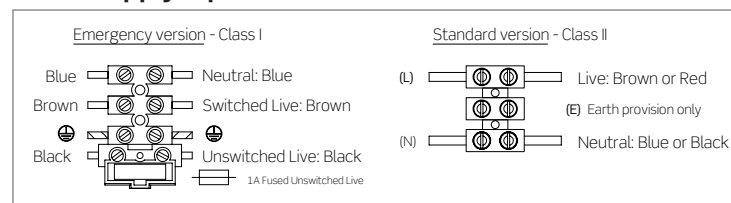

Emergency versions are Class I and earth is required. Non-emergency versions are Class II with earth provision only.

Figure.2

Dimming control Input DALI/1-10V

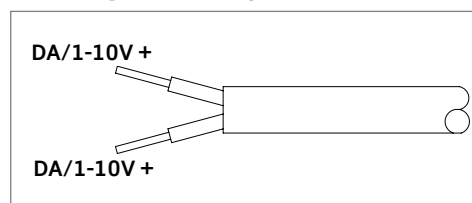
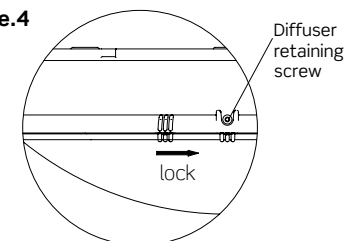

Figure.3

CCT switch



Figure.4



Emergency range routine inspection and test

All tests must be undertaken at times of least risk and in accordance with EN 50172:2004 as indicated below:

Weekly: Indicators of central power supply shall be visually inspected for correct operation.

Monthly: (in addition to the daily check) If automatic testing devices are used, the results of the short duration tests shall be recorded. Test shall be carried out as follows:

- a) Switch the luminaire over to emergency mode to operate from the batteries by simulating a failure of supply to the normal lighting for a period sufficient to ensure correct luminaire operation

NOTE: The period of simulation failure should be sufficient for the purpose of this clause whilst minimising damage to the system components e.g lamps. During this period, all luminaires and signs shall be checked to ensure that they are present, clean and functioning correctly. At the end of this test period, the supply to the normal lighting should be restored and any indicator lamp or device should be checked to ensure that it is showing that the normal supply has been restored.

Annually: If automatic testing devices are used, the results of the short duration tests shall be recorded. For all other systems the monthly inspection shall be carried out and the following additional tests made:

- a) Each luminaire and internally illuminated sign shall be tested monthly as above but for its full duration in accordance with the manufacturer's information.
- b) The normal supply for the luminaire should be restored and any charge indicator lamp or device should be checked to ensure that it shows the normal supply has been restored. The charging arrangements should be checked for proper functioning.
- c) The date of the test and its results shall be recorded in the system logbook.

A copy of this report must accompany any fitting returned to the manufacturer for any reason.

General Information

Our products are designed to comply with the requirements of UK law and the relevant industry national and international standards and should not be modified in any way. All emergency lighting systems should comply with the recommendations of BS5266-1: Code of Practice for the Emergency Lighting of Premises and be installed by competent engineers in accordance with the relevant wiring regulations. Before installing any type of Emergency Lighting always seek the advice and approval of the local Fire Prevention Officer (or equivalent authority).

Maintenance

Failed or faulty light sources connected to this equipment should be replaced immediately. These units are designed especially for a long and trouble free life. Under normal conditions, will require no routine maintenance or service beyond the inspection and test regime of BS5266-1.

Both mains supply and battery protection fusing is incorporated internally. Should access to these or any other part of the circuitry be required this must be undertaken only by suitably qualified person. Special care must be taken when removing the cover to circuitry and battery. Only replacement components authorised by the company must be used. Disposal of replaced components should be in accordance with the component manufacturers instructions.

Important warranty information

These products are supported by a 5 year extended warranty (batteries 2 years); which must be registered online at jcc.co.uk/warranty.

The installer will be asked to provide the following information; which is detailed on a label attached to the luminaire's chassis: Product Code/Date Code.

Profile & Dimensions

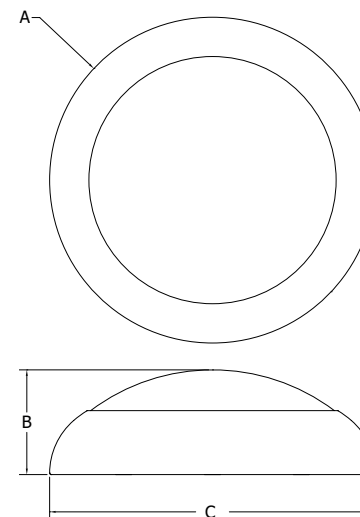

Wattage	A	B	C
8W	Ø262	87	262
12W	Ø343.6	99.7	343.6
18W	Ø343.6	99.7	343.6

All dimensions in millimetres

Emergency test record sheet

Month	Test Type	First Year		Second Year		Third Year		Fourth Year		Fifth Year	
		Sign	Date	Sign	Date	Sign	Date	Sign	Date	Sign	Date
January	Functional										
February	Functional										
March	Functional										
April	Functional										
May	Functional										
June	Functional										
July	Functional										
August	Functional										
September	Functional										
October	Functional										
November	Functional										
December	3 hour										

IP65

CE RoHS Compliant



V3_May_2019_RS

jcc.co.uk