

Installation Sheet

JC32012 Montella Mains Voltage Uplighter with PIR Halogen ES 42W E27

Montella Range Polycarbonate Lanterns

Please read these instructions before commencing installation.

240V 50Hz  IP44   

This fitting is Class II, Double Insulated, with Earth Provision.

Important Information

It is recommended that luminaires are installed by a qualified electrician to current IEE wiring regulations & local building control.

These products are designed for connection to a 240V 50Hz supply. Any broken or damaged parts should be replaced as soon as possible. JCC will not accept responsibility for any claims arising from a poor installation.

Installation Procedure

- 1) Unscrew capping nuts (2 off) on front of fitting then remove terminal housing cover at back.
- 2) Hold the terminal housing cover up to the wall in the desired fixing position, mark hole positions. This fitting must not be fitted to wet or damp surfaces such as freshly plastered or painted walls.
- 3) Cut hole in rubber grommet in terminal housing cover and feed mains cable through.
- 4) Drill holes on the points marked on the wall in step 2, use an Ø8mm drill bit and insert rawl plugs prior to screwing into position.
- 5) Connect the live and neutral cables to the 3-way terminal block and then relocate the connector into the terminal housing, see fig.2 for details.
- 6) Connect the fitting to the mains supply using the 'plug & play' connector and connect the PIR into the socket in the terminal housing using the connector attached to the 4-way ribbon cable.
- 7) Position the fitting onto the terminal housing that was secured to the wall in steps 2,3,4 and then secure using the capping nuts that were removed in step 1.
- 8) Remove lid by unfastening the fixings and screw lamp into lampholder, resecure lid into position.
- 9) Turn on mains supply to test the fitting.

Available Finishes: Black or White.

Important User Advice

Always switch off mains supply before servicing, fitting or replacing lamps. Always check the lamp is correct for the application, including its voltage and wattage. Never exceed the maximum Wattage. Ensure the lamp is correctly located in the lampholder.

PIR Specification

Time Delay: Max. 5 sec. ~ 6±2min.
 Ambient Light: <10Lux ~ 2000Lux
 Detection Distance: Max. 8±2m
 Detection Range: 140° - 180°
 Installation Height: 0.5 - 3.5m
 Power Consumption: 0.45W (Static 0.1W)
 Detection Motion Speed: 0.6 ~ 1.5m/s

Manual Override Function

- 1) Turn on the light at the switch.
- 2) Operate the switch Off/On, twice in 3 seconds.
- 3) The lamp will then flash 3 times to indicate that it is in 'Manual Override Status'. The lamp will then stay on.
- 4) The lamp will remain illuminated for up to 8 hours.
- 5) To cancel, Switch Off at the light switch & leave for 10 seconds.

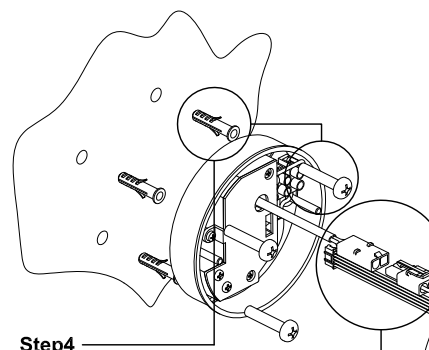

Step4
 Drill holes on the points marked in Step 2, insert Rawl Plugs & screw into position, typ. 3 pos'ns.

Step6
 Secure 'Plug & Play' & PIR connectors.

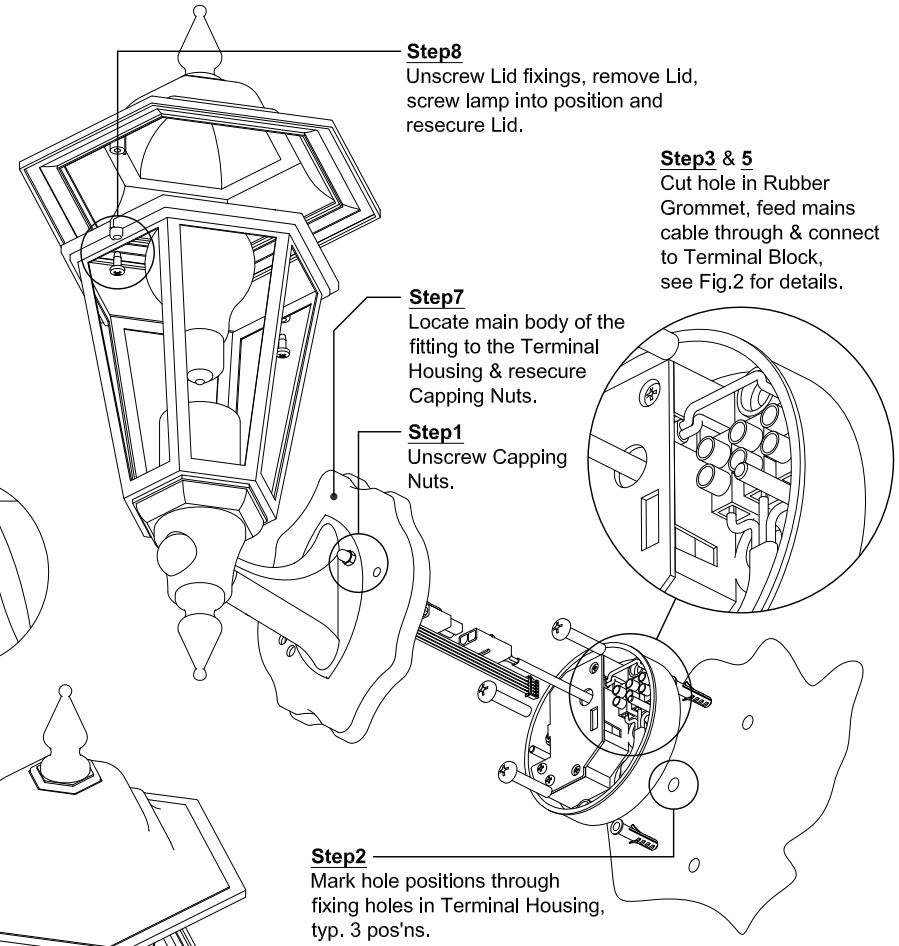

Step8
 Unscrew Lid fixings, remove Lid, screw lamp into position and resecure Lid.

Step3 & 5
 Cut hole in Rubber Grommet, feed mains cable through & connect to Terminal Block, see Fig.2 for details.

Step7
 Locate main body of the fitting to the Terminal Housing & resecure Capping Nuts.

Step1
 Unscrew Capping Nuts.

Step2
 Mark hole positions through fixing holes in Terminal Housing, typ. 3 pos'ns.

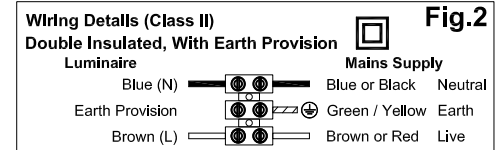

JCC Lighting Products recommends only branded lamp. For example: Sylvania, GE, Philips or Osram. 

Lamp Replacement
Lamp: Halogen ES
Lamp Cap: E27
Max Wattage: 42W
Max. Voltage: 240V 50Hz

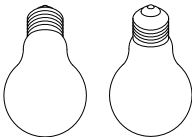

JCC Lighting Aftersales
 Technical Support Helpline: 01243 838986
 Customer Service Department: 01243 838999

