



Read these instructions before commencing installation

This Product is Class I and must be Earthed.

IP65 0.5m 240V 50W Max.

Important Information

It is recommended that luminaires are installed and fitted by a qualified electrician ensuring the installation complies to the current building regulations and BS7671.

These products are designed for connection to a 240V 50Hz Mains supply. Any broken or damaged parts should be replaced as soon as possible. JCC will not accept responsibility for any claims arising from a poor installation.

Important User Advice

Always switch off mains supply before servicing, fitting or replacing lamps. Always check the lamp is correct for the application, including its voltage and wattage.

This luminaire is suitable for indoor use only and should not be fitted to damp or wet surfaces such as freshly plastered or painted walls.

Installation Procedure

JCC recommends that a sample hole is cut in some scrap material to familiarise yourself with the installation. Once you are completely satisfied:

Cut a Ø74mm hole in ceiling and ensure adequate minimum ceiling void without infringing on joist, water pipes and electrical cables.

Connect this product to a mains voltage supply.

Fit this product as per illustration shown in Fig.1 Do not fit onto new plaster or damp areas.

Ensure there is adequate free air ventilation around the fitting.

Place lamp into lampholder and turn on the mains supply to test the luminaire.

Further adjustment to the lamp position should be done with extreme care as the lamps will get very hot very quickly. Never touch a hot lamp.

JCC Lighting Aftersales:
 Technical Support Helpline : 01243 838986
 Customer Service Department : 01243 838999



Lighting for today, designs for tomorrow

BS EN ISO9001 - 2008
 Registered Firm
 Certificate No. GB 1552



Product Information

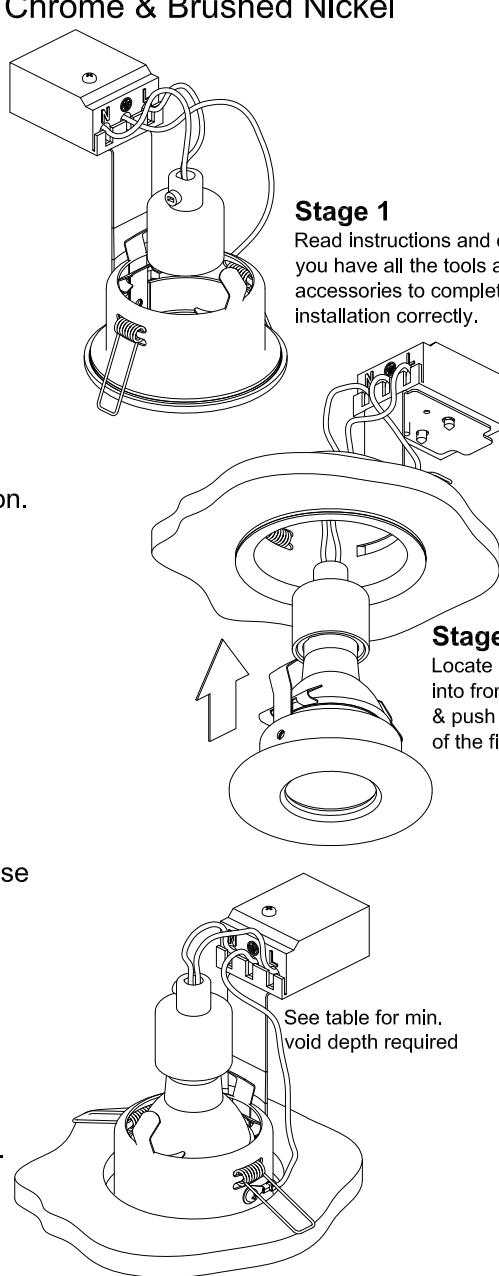

Stage 1
 Read instructions and check you have all the tools and accessories to complete the installation correctly.

Fig.1

Stage 4
 Locate 50W GU10 Lamp into front face of luminaire & push up into the main body of the fitting.

Stage 2
 Cut hole in ceiling, connect luminaire to 240V mains supply, press springs back & push main body of the luminaire into aperture.

Stage 3
 Locate 50W GU10 Lamp into Lampholder.

Ceiling Cut out Ø74mm

Mains Voltage Showerlight

JCC Model No	ØRim Size	ØCut out	Void Depth Req'd	Max Wattage / Lamp Type
JC2107	83mm	74mm	130mm	GU10 50W

JCC Lighting Products recommends only branded lamps. For example: Sylvania, GE, Philips or Osram.



Lamp replacement

Max Wattage: 50W
 Lamp Cap: GU10

